

## Goose Foot Street Furniture - Latest Case Studies



**Goose Foot Street Furniture** was selected by **Lancashire County Council** and the **Urban Architects Planit-IE** to design and manufacture bespoke 4 metre long seats to be placed throughout **Fishergate, Preston** as part of the **Fishergate Central Gateway Project**.

### Case Study: Fishergate Central Gateway - Preston

**Project:** Fishergate Central Gateway Project  
**Client:** Lancashire County Council  
**Location:** Fishergate, Preston  
**Collaboration:** Planit-IE

**Details:**

The project focuses on the delivery of a high quality public realm with re-configuration of key gateways. Designed to enhance the overall attractiveness of the City Centre as a viable business location and act as a catalyst for private sector inward investment.

One of the main themes of the project is to create a sense of place by enhancing the architectural heritage with a new shared space scheme to bring Fishergate into the 21st century.

The design of this bespoke seating is stylish yet engineered to be durable and practical. In total, Lancashire County Council ordered 9 of the iconic seats which are placed evenly throughout the new scheme.

Goose Foot is proud to have been chosen as a key partner in the city's ongoing regeneration.

Preston City Centre has seen many benefits as a result of the Fishergate Central Gateway Project, which has significantly improved the main approaches to the City Centre.





# Case Study

## Colwyn Bay Seats by Freshwest Design



**Project:** Waterfront Regeneration

**Client:** Conwy Borough Council

**Location:** Colwyn Bay, Wales

**Collaboration:** Freshwest Design

**Details:**

**Goose Foot were selected by Freshwest Design to work together in producing ten eye catching seats and benches for the Colwyn Bay promenade, as part of the Colwyn Bay Waterfront Regeneration Project.**

The seat frames were laser cut and fabricated at our state-of-the-art factory in Darwen, UK, using 316 marine grade stainless steel and kebyony syp timbers. The final fabrication, assembly and installation was undertaken by Freshwest Design. These bespoke seats were specifically designed to stop people in their tracks and provoke discussion from the general public.

The Colwyn Bay Waterfront Project combines the renewal of coastal defences with regeneration improvements to the promenade, creating a modern, sustainable and attractive waterfront. A key element of the project is the idea of circular movement – to encourage people using obvious road and pedestrian signs to travel along the promenade, up to the town centre and up to Old Colwyn near Parc Eirias.



## Case Study

### ITV HQ Bespoke Seating - Media City, Salford



**Project:** Interactive Seating Installation  
**Client:** ITV Headquarters  
**Location:** Media City, Salford, Manchester  
**Collaboration:** Kin Design

#### Details:

We worked closely with our parent group WEC and Kin Design to produce a stainless steel outdoor seating installation for the ITV HQ at Media City in Salford. The seating is completely bespoke and designed to create a social seating area for the public and staff to use.

The 16m long stainless steel 'ribbon' was formed and fabricated over a period of 8 weeks to match Kin Designs' CAD model. The sections were individually polished to a uniform super satin finish including the blending and dressing of all the welded joints.

For the installation, the piece was delivered in three sections and lifted into place using a 100t Hi-ab crane, positioned, fixed to the ground, welded, re-polished and painted on site.

Goose Foot works closely with councils across the UK to design and manufacture street furniture, whether in batch orders or one-off bespoke products.

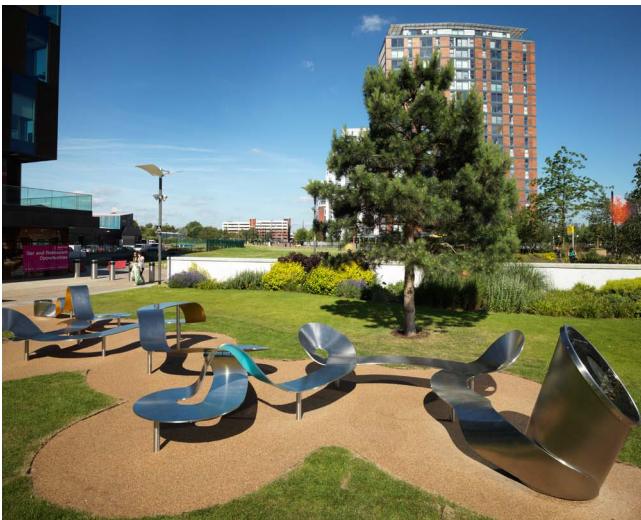



## Case Study

### WW1 War Memorial Bespoke Seating - Folkestone, Kent



**Project:** War Memorial and Bespoke Seating

**Client:** Step Short Educational Charity

**Location:** Remembrance Rd, Folkestone, Kent

**Collaboration:** m-tec - [www.m-tec.uk.com](http://www.m-tec.uk.com)

#### Details:

Goose Foot Street Furniture and sister company m-tec were commissioned by the educational charity Step Short to manufacture the completely bespoke seating and iconic stainless steel arch. Unveiled by Prince Harry in August 2014, the project marks the centenary of the outbreak of World War 1.

To accompany the iconic arch, Goose Foot designed and manufactured the bespoke wall mounted benches using marine grade 316 stainless steel and Iroko slats to fit seamlessly into the recesses. The benches create a timeless feature within the town centre and blend into the surroundings perfectly.

The project marks the route taken by many of the men, a large number of whom would not return, marching down the Road of Remembrance to board the ships.

Graham Wood, Divisional Manager of Goose Foot Street Furniture Ltd, said: "We are honoured to be a part of the project, as it's such a special way to remember those who sacrificed so much for the country during the War."

**STEP SHORT**  
m-tec





## New Street Furniture Products Now Available



Tula Curved Seat

**We are pleased to announce that we have expanded the Goose Foot Street Furniture range and introduced some fantastic new seating concepts.**

The Tula curved seating range is not only aesthetically pleasing, but it also enhances the functionality of public spaces. The modular design of the curved seats and benches makes it possible to manufacture the seating to any length, suiting your specifications. Both are also available as a circular tree seat/bench.

The length and product options essentially make the curved seating a bespoke street furniture solution for any urban project or as a one-off. Both the seats and benches are available as mild steel in a choice of RAL colours or as satin polished stainless steel.



Tula Curved Bench



Lander Timber Slatted Seat

We also recently added the Lander Timber Slatted Seat to our standard street furniture range. Like some of our other timber slatted seats, the Lander features a mild steel frame and hardwood slats made from renewable sources and has been designed for comfort, style and durability.

Great for public spaces, the timber slatted seat it is available as 1800mm as standard size or 2000mm optional size.



## Goose Foot Street Furniture Product Range



Goose Foot Street Furniture  
Britannia House,  
Junction Street,  
Darwen, Lancashire,  
BB3 2RB

t: +44 (0) 1254 700213

e: [enquiries@goosefootuk.com](mailto:enquiries@goosefootuk.com)

[www.goosefootuk.com](http://www.goosefootuk.com)

### Unique, Modern, Comfortable and Built to Last!

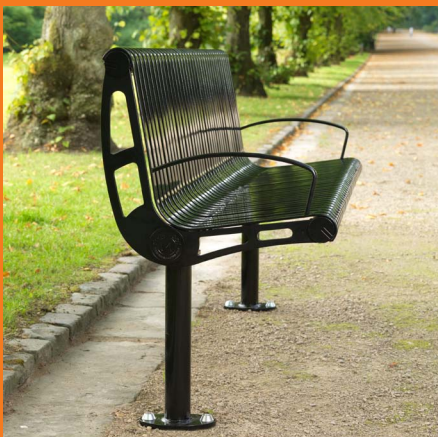

**Seats**



**Benches**



**Bollards**



**Cycle Stands**



**Litter Bins**



**Bespoke**